

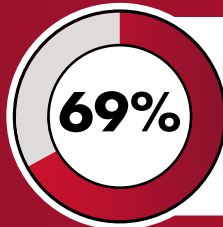

PLANNING FOR A SUSTAINABLE FUTURE

On November 4, Belle Plaine Public School District residents will vote on a long-term plan to operate more efficiently while improving our school buildings to better serve students and the community.

SURVEY RESULTS from Belle Plaine Residents



Residents say it's **important** to ensure safety & security at all of our buildings

Community members **support** a plan to right-size the district

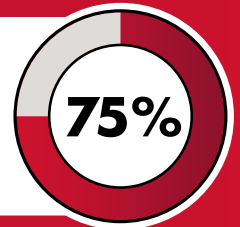

PROJECT HIGHLIGHTS



ENHANCE SAFETY + SECURITY

While our schools have secure entrances, **they do not meet current standards for proper supervision and control of visitor access.** The plan would reconfigure our buildings to make entrances more secure, improve parent and bus traffic patterns, and eliminate the need for students to move between buildings during the school day.



OPTIMIZE OPERATIONAL EFFICIENCIES

The district maintains more space than needed, making upkeep increasingly costly. The plan would reduce the number of buildings we maintain from four down to two, saving approximately \$400,000 annually in operating costs, eliminating the need for student shuttles, and reducing the overall footprint by 35,000 square feet.



EXPAND EDUCATIONAL EXPERIENCES

Our schools need better spaces to help all students succeed. As interest in trades, manufacturing, and service careers grows, our current facilities can't support proper training. The plan addresses this by updating learning spaces, expanding Career and Technical Education (CTE) and Fine Arts areas for middle and high school students, and bringing all elementary students into one building to improve collaboration, services, and support.

PROPOSED FACILITY CONSOLIDATION & REDESIGN

Transform the **Middle & High School** into a
Pre-Kindergarten-5th Grade Elementary School
(Conceptual Rendering)



Expand and Redesign **Oak Crest Elementary** to
serve as the new **6th-12th Middle & High School**
(Conceptual Rendering)



The closure of **Chatfield Grade School** and the **PAC/District Office** (theater, shop, Ag., SOAR) will **save approximately \$400,000 each year** and allow us to operate two high-quality, modern campuses instead of aging buildings. This will ensure we continue to deliver an excellent education for every student.



13.7% Paid for by State of Minnesota (Ag2School)

- 64.2% Residential
- 13.7% Ag2School Credit
- 10.9% Commercial/Industrial
- 5.9% Agricultural
- 5.2% Other Funding Sources

ESTIMATED TAX IMPACT

Borrowing amount not to exceed \$65,000,000

Use the tax calculator on the website of the district's independent municipal advisor.
Scan here for your estimated tax impact!



www.isd716.org/tax-calculator

Type of Property	Est. Market Value	Est. Impact on Taxes Payable in 2026	
		Annual	Monthly
Residential Homestead	\$150,000	\$117.56	\$9.80
	\$200,000	\$172.32	\$14.36
	\$250,000	\$227.09	\$18.92
	\$300,000	\$281.85	\$23.49
	\$400,000	\$391.37	\$32.61
Commercial / Industrial*	\$250,000	\$427.04	\$35.59
	\$500,000	\$929.45	\$77.45
	\$1,000,000	\$1,934.26	\$161.19
Ag. Homestead (Value per acre)**	\$7,500	\$1.13	\$0.09
	\$10,000	\$1.51	\$0.13
	\$12,500	\$1.88	\$0.16
Ag. Non-Homestead (Value per acre)	\$7,500	\$2.26	\$0.19
	\$10,000	\$3.01	\$0.25
	\$12,500	\$3.77	\$0.31

* Ag Homestead examples exclude the house, garage and one acre which has the same tax impact as a residential homestead property

** The Ag2School Property Tax relief bill passed in May 2019 provides debt service tax relief of levy payments of 70% for taxes payable in 2023 and beyond for qualifying agricultural and timber properties

Prepared and paid for by Independent School District No. 716 (Belle Plaine Public Schools), 220 S. Market Street, Belle Plaine, MN 56011. This publication is not circulated on behalf of any candidate or ballot questions.

Current Middle & High School
RENOVATED to become our
PreK-5th Grade **ELEMENTARY**
SCHOOL

- 1 Remodel classrooms to meet the needs of elementary students
- 2 Remodel special education spaces
- 3 Remodel restrooms to meet the needs of elementary students
- 4 Enhance safety and security at the main entrance
- 5 Improve traffic flow

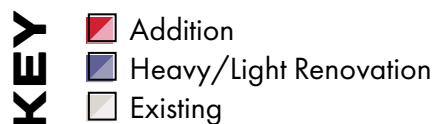

Current Oak Crest Elementary
to become our **RENOVATED +**
EXPANDED MIDDLE &
HIGH SCHOOL

- 1 Secure front entrance and office remodel
- 2 Construction of classroom additions
- 3 Expansion to support existing Career and Technical Education (CTE) programs
- 4 New Auditorium with approx. 500 seats to replace old theater
- 5 Add gym, locker rooms, and weight/fitness room
- 6 New band and choir classrooms
- 7 Special education space improvements
- 8 Flexible learning spaces for student collaboration
- 9 New parking lot across the street next to athletic complex parking lot

PRELIMINARY PLAN
PreK-5th Grade Elementary School

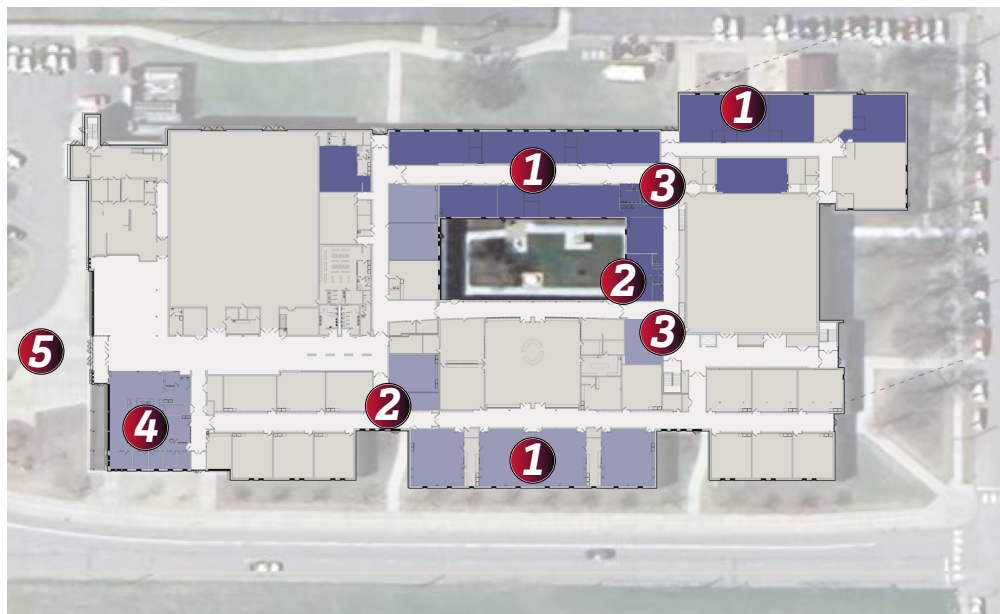

PRELIMINARY PLAN
6th-12th Grade Middle & High School

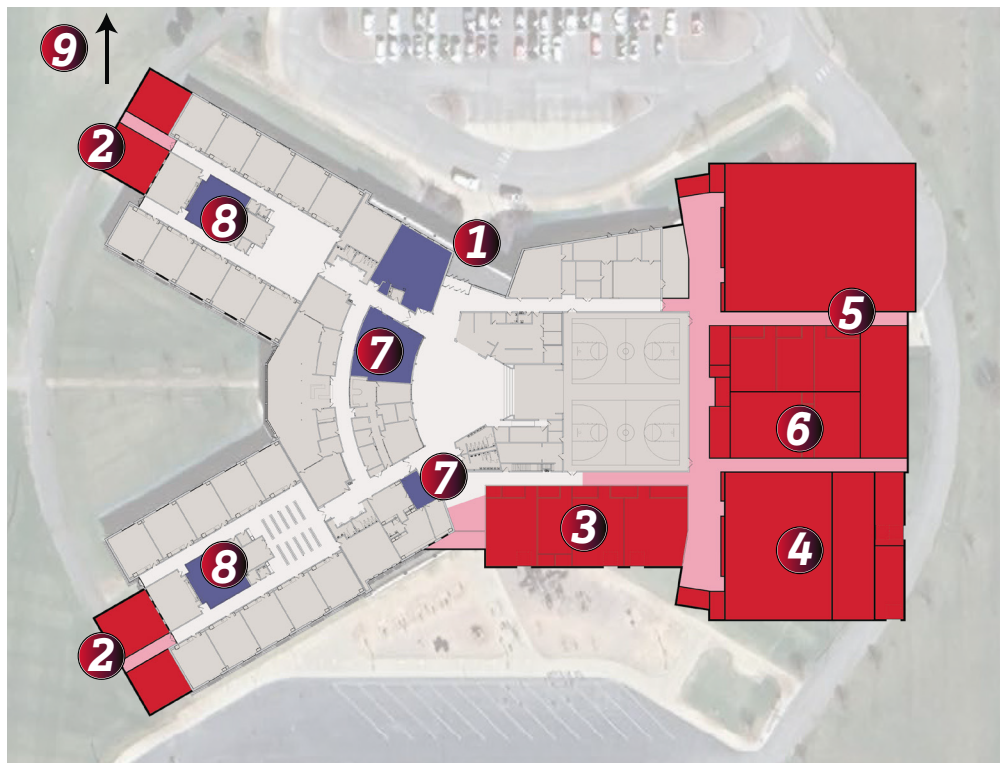

WHY INVEST NOW?

The facility assessment estimates **more than \$50 million in capital facility improvements over the next 10 years just to keep our current buildings operational**—this does not include essential safety, security, and educational space updates to meet standards seen in neighboring districts.

If this referendum does not pass, the District will need to address these needs through other school taxes while not achieving the annual operational cost savings that the proposed referendum provides.



BELLE PLAINE PUBLIC SCHOOLS

220 S. Market St.
Belle Plaine, MN 56011

**JOIN US FOR COMMUNITY
INFORMATIONAL MEETINGS**

All meetings will be held in **Oak Crest Elementary
Cafeteria** from **6:00 PM** to **7:00 PM**

- Thursday, September 18
- Tuesday, October 7
- Thursday, October 30

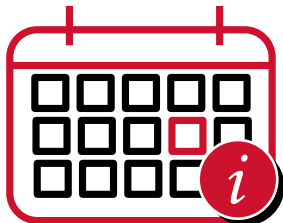

VOTING INFORMATION

EARLY VOTING

(District Office, High School North Entrance - Door M)
September 19–November 3, 2025
Weekdays 8:00 a.m. - 4:00 p.m.

ELECTION DAY VOTING

(City Hall)
Tuesday, November 4, 2025
7:00 a.m. - 8:00 p.m.



- (952) 873-2400
- rlaager@belleplaine.k12.mn.us
- www.isd716.org/referendum